

ZXM6-NH120 Series

Znshinesolar 9BB HALF-CELL Black Mono PERC PV Module



120

Mono Poly Solutions

350W | 355W | 360W | 365W | 370W

Made with selected materials and components to grant quality, duration, efficiency and through outputs, the ZXM6-NH120 monocrystalline modules by ZNSHINE SOLAR(power output 350 up to 370Wp, represent a highly flexible solution for diverse installation types, from industrial rooftop plants to small home PV systems or large ground surfaces. This allows you to produce clean energy while reducing your energy bill.

ZNSHINE SOLAR' S ZXM6-NH120 Monocrystalline solar modules are tested and approved by international acknowledged laboratories, so that we can offer our customers a reliable and price-quality optimized product. The linear warranty on product outputs further ensures increased security and return on investments over time.

12 years product warranty/25 years output warranty

0.55% Annual Degradation over 25 years

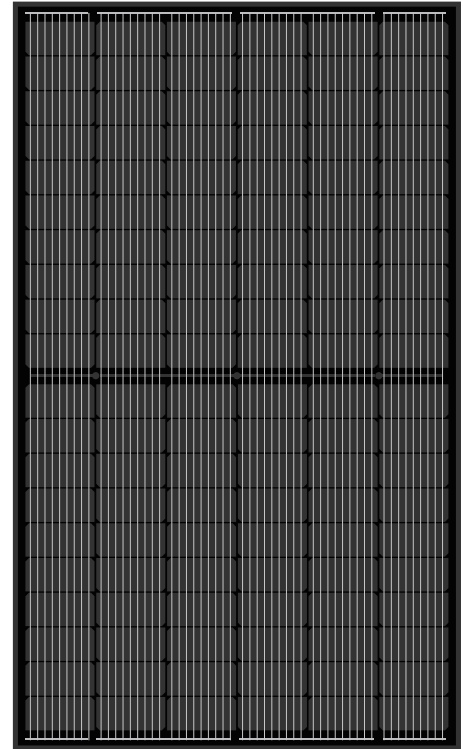
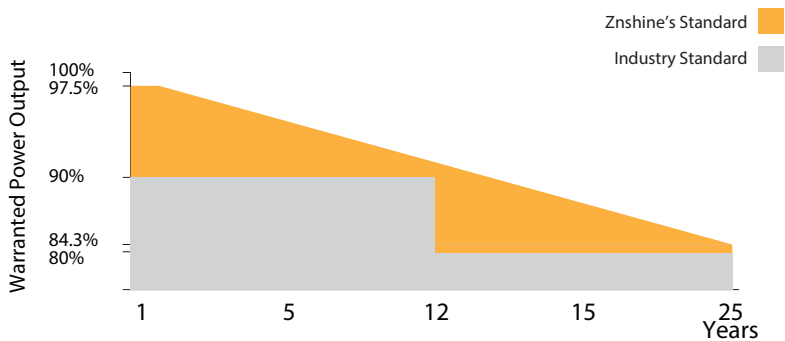

9 Busbar Solar Cell

No power loss thanks to improved temperature co-efficient caused by 9 busbar solar cell



High Efficiency

Graphene coating can increase about 2W of the module efficiency by rising around 0.5% of the light transmission



Anti PID

Limited power degradation of ZXM6-NH120 module caused by PID effect is guaranteed under strict testing condition for mass production



Better Weak Illumination Response

Lower temperature coefficient and wide spectral response, higher power output, even under low-light settings



Certified to withstand the most challenging environmental conditions

5400 Pa snow load
2400 Pa wind load



Graphene Coating

Graphene coating modules can increase power generation and self-cleaning, also can save maintenance cost



ZNShine PV-Tech Co., LTD, founded in 1988, is a world-leading high-performance PV module manufacturer, PV power station developer, EPC and power station operator. With its state-of-the-art production lines, the company boasts module output of 5GW. Bloomberg has listed ZNShine as a global Tier 1 PV manufacturer and Top 4 reliable PV supplier.

www.znshinesolar.com

ZXM6-NH120 Series **Znshinesolar 9BB HALF-CELL Black** Mono PERC PV Module



ELECTRICAL PROPERTIES | STC*

Module Type	ZXM6-NH120-350/M	ZXM6-NH120-355/M	ZXM6-NH120-360/M	ZXM6-NH120-365/M	ZXM6-NH120-370/M
Nominal Power Watt Pmax(W)	350	355	360	365	370
Power Output Tolerance Pmax(%)	0~+3	0~+3	0~+3	0~+3	0~+3
Maximum Power Voltage Vmp(V)	33.4	33.6	33.8	34.0	34.2
Maximum Power Current Imp(A)	10.48	10.57	10.66	10.74	10.82
Open Circuit Voltage Voc(V)	40.2	40.4	40.6	40.8	41.0
Short Circuit Current Isc(A)	11.04	11.14	11.24	11.33	11.42
Module Efficiency (%)	19.21	19.49	19.76	20.04	20.31

*STC (Standard Test Condition): Irradiance 1000W/m², Module Temperature 25°C, AM 1.5
*The data above is for reference only and the actual data is in accordance with the practical testing

ELECTRICAL PROPERTIES | NMOT*

Maximum Power Pmax(Wp)	256.1	259.8	263.5	267.1	270.6
Maximum Power Voltage Vmpp(V)	30.9	31.1	31.3	31.4	31.6
Maximum Power Current Impp(A)	8.28	8.36	8.43	8.50	8.57
Open Circuit Voltage Voc(V)	37.2	37.4	37.6	37.8	38.0
Short Circuit Current Isc(A)	8.92	9.00	9.08	9.15	9.22

*NMOT(Nominal module operating temperature):Irradiance 800W/m²,Ambient Temperature 20°C,AM 1.5,Wind Speed 1m/s
*The data above is for reference only and the actual data is in accordance with the practical testing

TEMPERATURE RATINGS

NMOT	44°C ±3°C
Temperature coefficient of Pmax	-0.36%/°C
Temperature coefficient of Voc	-0.29%/°C
Temperature coefficient of Isc	0.05%/°C

*Do not connect Fuse in Combiner Box with two or more strings in parallel connection

MECHANICAL DATA

Solar cells	Mono PERC 166×83mm
Cells orientation	120 (6×20)
Module dimension	1755×1038×35 mm
Weight	20.5 kg
Glass	High transparency,low iron,tempered
	Glass 3.2 mm (AR-coating)
Junction box	IP 68, 3 diodes
Cables	4 mm ² ,350 mm
Connectors	MC4-compatible

WORKING CONDITIONS

Maximum system voltage	1500 V DC
Operating temperature	-40°C~+85°C
Maximum series fuse	20 A
Maximum load(snow/wind)	5400 Pa / 2400 Pa

DIMENSION OF THE PV MODULE (mm)

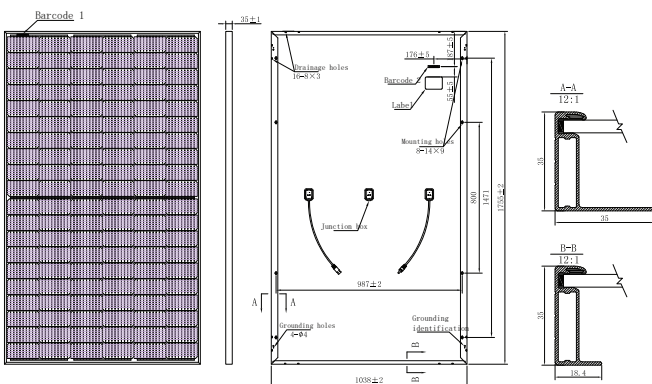

PACKAGING INFORMATION

Packing Type	40' HQ
Piece/Box	30
Piece/Container	780

I-V CURVES OF THE PV MODULE

